



Light Fitting for Fluorescent Lamps Series ECOLUX 6600

- Explosion protection to EN 50 021 and EN 50 281
- For use in
 - Zone 2
 - Zone 21 and Zone 22
- For installation as
 - pendant light fitting
 - pole-mounting light fitting
 - bulkhead light fitting
- With electronic ballast (1- or 2-channel)
- For two pin fluorescent lamps
- 1- or 2-lamp version: 18 W, 36 W or 58 W
- Enclosure in polyester resin, glass fibre reinforced and cover in polycarbonate, impact-resistant
- Quick fasteners
- Light fittings with VVGs on request

The light fittings series 6600 are useable for normal lighting, but also as group or centrally-supplied emergency light fitting.

STAHL

Zones 2, 21 & 22

Selection table				
Version	Lamps	Electronic ballast	Ordering code	Weight kg
ECOLUX 6600 , for use in Zones 2, 21 & 22	1 x 18 / 20 W	1 channel ECG	6600/521-8..0-223.	2,500
	2 x 18 / 20 W	1 channel ECG	6600/522-8..0-223.	2,500
		2 channel ECG	6600/522-9..0-223.	2,900
	1 x 36 / 40 W	1 channel ECG	6600/541-8..0-223.	4,600
	2 x 36 / 40 W	1 channel ECG	6600/542-8..0-223.	4,600
		2 channel ECG	6600/542-9..0-223.	5,000
	1 x 58 / 65 W	1 channel ECG	6600/561-8..0-223.	5,800
	2 x 58 / 65 W	1 channel ECG	6600/562-8..0-223.	5,800
2 channel ECG		6600/562-9..0-223.	6,200	
Add. to ordering code				
Through wiring	Standard: without		6600/...-0-...-...	
	Special: with 3 cores		6600/...-3-...-...	
Cable entries	Standard: M 25 x 1.5 1 cable entry 2 stopping plugs		6600/...-1-...-...	
	Special: M 20 or M 25 moulded of plastic or metal State with order		6600/...-9-...-...	
Monitoring module	Standard: without		6600/...-...-...-0	
	Sonder: 6448/11-02 Adressbaustein (STAHL)		6600/...-...-...-2	
Note	The light fittings are supplied without tubes and mounting accessories. These parts must be ordered separately.			

Technical Data	
Explosion protection	
Gas explosion protection	for Zone 2: II 3 G EEx nA II T4
Dust explosion protection	for Zone 21: II 2 D IP 66 T80 °C* for Zone 22: II 3 D IP 66 T80 °C*
	* T 80 °C = max. surface temperature referred to
	18 W, 36 W: T _a = + 55 °C 58 W: T _a = + 45 °C
Certificates	
Gas explosion protection	Zone 2: DMT 01 E 085
Dust explosion protection	Zone 21: DMT 01 ATEX E 086X Zone 22: DMT 01 E 085
Other certificates	IECEX
Marking	CE 0102
Lamps	Two pin-fluorescent lamps \varnothing 26 mm or \varnothing 38 mm, socket G13 1 x 18 / 20 W 2 x 18 / 20 W 1 x 36 / 40 W 2 x 36 / 40 W 1 x 58 / 65 W 2 x 58 / 65 W
Rated Voltage	AC: 198 V ... 264 V 50 / 60 Hz DC: 154 V ... 276 V
Rated current	at 230 V / 50 Hz; for light fittings version
	18 / 20 W 36 / 40 W 58 / 65 W
	1 lamp 0.1 A 0.18 A 0.25 A 2 lamps 0.18 A 0.33 A 0.49 A



Technical Data

Luminous intensity distribution

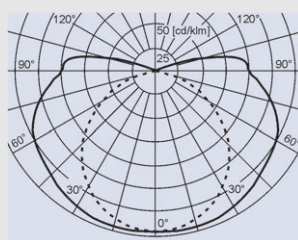

C90 C45
C180 C0
C270
08258E00

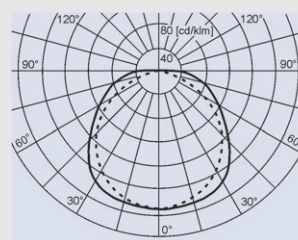

C90 C45
C180 C0
C270
08257E00

Version 1-lamp, without reflector

1-lamp, with reflector

Accuracy class B21
acc. to LitG

B31

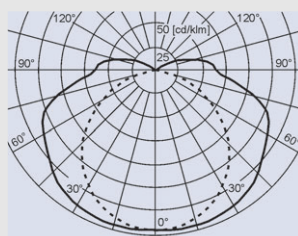

C90 C45
C180 C0
C270
08259E00

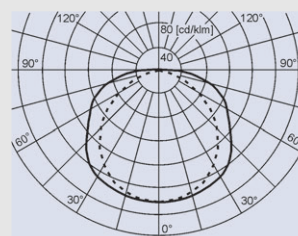

C90 C45
C180 C0
C270
08257E00

Version 2-lamp, without reflector

2-lamp, with reflector

Accuracy class B21
acc. to LitG

B31

Monitoring module

Function

Monitoring and switch module for central battery systems in accordance to VDE 0108:
The module is capable of performing the single monitoring of light fitting and the combined circuit of normal and emergency light fittings.
The module offers the following functionality:

- Control of the light fitting (ON / OFF) and function testing
- Within one circuit it is possible to operate up to 20 modules via a coding switch
- Each single device within a circuit can be programmed as: permanent light, stand-by light and switched light
- Mixed operation of modules in one circuit possible

Input voltage

(Input between L+ and N-)
U_N 230 VAC (+10%/-15%); 50 Hz
U_{DC} 175 V ... 275 VDC

Control input

(between L and N)
U_N 230 VAC (+10%/-15%); 50 Hz

Connection power (Output)

P 4 W ... 100 W

Ambient temperature limit

t_{a (Modul)} - 10 °C ... + 50 °C

Dimensions

L x B x H = 95 mm x 40 mm x 32 mm

Installation notes

Looping through of cables

There are 2 M 25 x 1.5 cable entries on the connection side for looping through of connection cable (entry and exit on one side).

Through wiring

Fittings can be supplied with internal through-wiring.
Entry and exit holes for connection cables are positioned on opposite sides.
A through-wiring kit can be fitted after manufacture (see accessories).
Terminals: See technical data top
Wiring cross-section: 2.5 mm² for max. 16 A



Technical Data

Mounting

Standard

2 x M 8 inserts in housing

Special





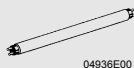
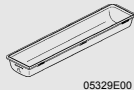
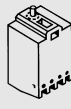
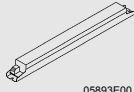
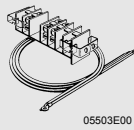

Mounting grooves in housing to accommodate bracket fitting and ceiling rails for variable light installation.

Variable mounting distances of light fittings; see dimension drawings

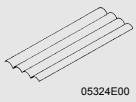
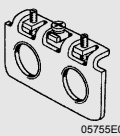
Accessories and spare parts

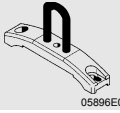
Designation	Illustration	Description	Ordering code	Weight kg
Fluorescent lamp	 04936E00	Two pin base \varnothing 26 mm Light colour: Universal white		
		18 W 1100 lm	4617220	0,100
		36 W 2600 lm	4617210	0,200
		58 W 4100 lm	4617200	0,283
Diffuser cover	 05329E00	For lamp 18 / 20 W	6600001050	0,500
		For lamp 36 / 40 W	6600002050	0,800
		For lamp 58 / 65 W	6600003050	1,000
Switch	 05651E00	Switch element 8080/1-3-L, 2 NC	8080006600	0,025
Ballast	 05893E00	1 x 18 W 1-channel	3657680	0,276
		2 x 18 W 1-channel	3657070	0,400
		1 x 36 W 1-channel	3657690	0,292
		2 x 36 W 1-channel	3657060	0,400
		1 x 58 W 1-channel	3657700	0,300
		2 x 58 W 1-channel	3657050	0,400
Mounting kit for through wiring	 05503E00	For later installation into standard-light fitting		
		DV3, tension clamp terminals 3 x 2.5 mm ² , max. 16 A terminal marking: L1 + N + PE		
		18 W / 20 W	6600810870	0,300
		36 W / 40 W	6600811870	0,300
		58 W / 65 W	6600812870	0,300
		DV5, tension clamp terminals 5 x 2.5 mm ² , max. 16 A terminal marking: L1 + L2 + L3 + N + PE		
		18 W / 20 W	6600807870	0,300
		36 W / 40 W	6600808870	0,300
		58 W / 65 W	6600809870	0,300
		DV3, screw terminals 3 x 2.5 mm ² , max. 16 A terminal marking: L1 + N + PE		
		18 W / 20 W	6600804870	0,400
		36 W / 40 W	6600805870	0,400
		58 W / 65 W	6600806870	0,400
DV5, screw terminals 5 x 2.5 mm ² , max. 16 A terminal marking: L1 + L2 + L3 + N + PE				
18 W / 20 W	6600801870	0,400		
36 W / 40 W	6600802870	0,400		
58 W / 65 W	6600803870	0,400		

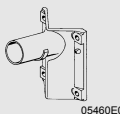
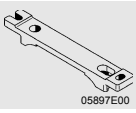

Accessories and spare parts					
Designation	Illustration	Description	Ordering code	Weight kg	
Reflectors	 05324E00	For later installation, broad deep-beam			
		For 1-lamp light fittings 18 W / 20 W	6030903580	0,082	
		For 1-lamp light fittings 36 W / 40 W	6030904580	0,172	
		For 1-lamp light fittings 58 W / 65 W	6030906580	0,218	
		For 2-lamp light fittings 18 W / 20 W	6030901580	0,110	
		For 2-lamp light fittings 36 W / 40 W	6030902580	0,234	
		For 2-lamp light fittings 58 W / 65 W	6030905580	0,290	
Adapter plates	 05755E00	For earthing continuity when metal glands are used			
		1 x M 20 x 1.5	1 pc	6000815550	0,070
		1 x M 25 x 1.5	1 pc	6000816550	0,070
		1 x NPT 1/2"	1 pc	6000817550	0,070
		1 x NPT 3/4"	1 pc	6000818550	0,070
		2 x M 20 x 1.5	1 pc	6000819550	0,060
		2 x M 25 x 1.5	1 pc	6000820550	0,060
Lamp-holder	 05888E00	Lamp-holder for 2-pin base lamps G 13	3856630	0,008	
Mounting rail	 05895E00	For variable mounting 1 pair	6600801750	0,420	
Mounting clamp bracket	 05896E00	Installation clamp mounted on installation rail for variable mounting distances	1 pair	6600802750	0,150
Ring bolts	 05378E00	M 8, to mount directly into inserts, 1 pair	6000803900	0,107	
Wall-mounting bracket	 05460E00	For pole-mounting fitting with extension tube 1300 mm in length, Ø 42 mm (for pipe clamp R1 1/2")	4637490	6,000	
Ceiling mounting bracket	 05897E00	For ceiling mounting of light fitting 1 pair	6600803750	0,230	
Pipe clamps	 09402E00	with mounting rail for variable mounting distances; material: stainless steel			
		R 1 1/4" (Ø 42 mm)	6600805260	1,100	
		R 1 1/2" (Ø 48 mm)	6600801260	1,100	
		R 2" (Ø 60 mm)	6600802260	1,300	

Dimension drawings (all dimensions in mm) - subject to alterations

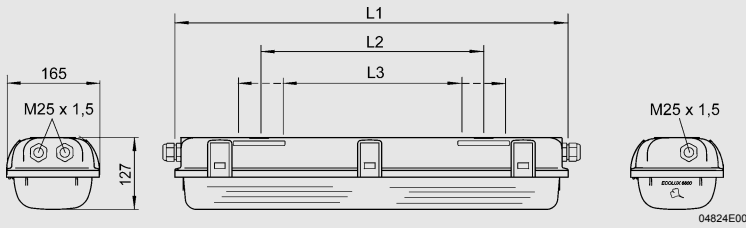

Dimensions	Light fitting		
	18 / 20 W	36 / 40 W	58 / 65 W
L1	700	1310	1610
L2 ¹⁾	400	800	800
L3 ²⁾	340 ... 460	680 ... 920	795 ... 1030

- 1) Fixed mounting distance
2) Variable mounting distance

Light fittings ECOLUX 6600, 18 W, 36 W, 58 W

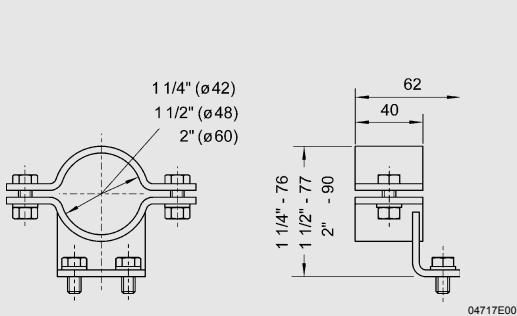

Pipe clamp

04717E00

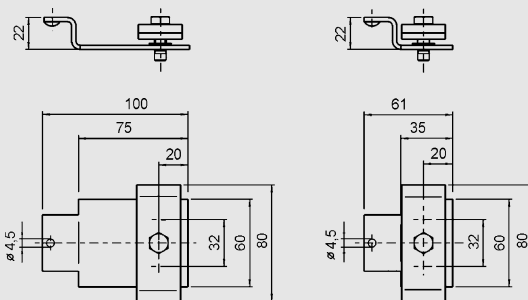

Mounting set grid cable rack

04822E00

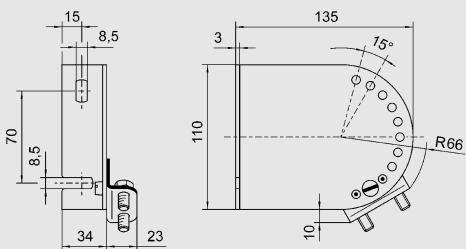

Ceiling- and wall-mounting bracket

04716E00

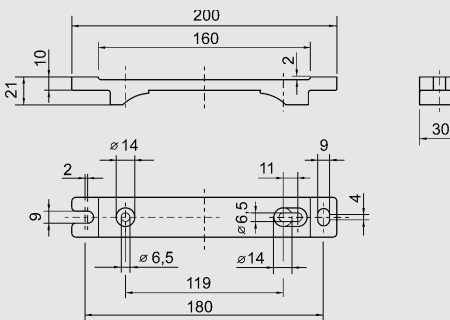

Ceiling mounting bracket

04833E00

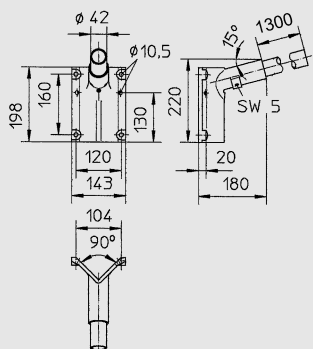

Wall mounting bracket for pole-mounting version

04823E00

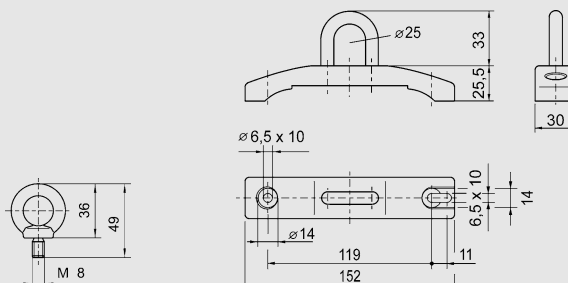

Ring bolt

Mounting clamp bracket

04715E00

Installation accessories

We reserve the right to make alterations to the technical data, weights, dimensions, designs and products available without notice. The illustrations cannot be considered binding.

